

**Carcass:** Cabinet panels are constructed from high-performance 18mm melamine faced high density particle board. All carcasses are edged in 1mm ABS edging to match carcass colour, with all fronts edged in 2mm high impact ABS for added protection. Each unit can be fitted internally with anti-bacterial liners for a range of trays or shelving, with the additional option of telescopic runners for heavier items.

**Backs:** Cabinet backs are constructed from high-performance 18mm melamine faced high density particle board for added strength and stability.

**Shelves:** Manufactured from high-performance 15mm melamine faced high density particle board with all edges in 1mm ABS to match shelf colour.

**Plinths:** All base units are supported by four fully adjustable feet, with 18mm melamine faced high density particle board plinths. These are supplied continuous in lengths and include floor sealing strips for additional protection in wet areas.

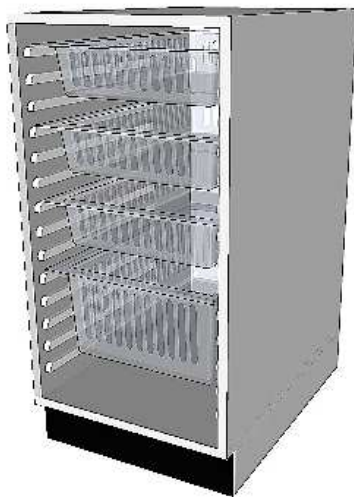

### BC490

.....  
WIDTH  
455mm  
.....  
DEPTH  
658mm  
.....  
HEIGHT  
900mm  
.....  
DOOR OPTIONS:  
MFC, Tambour &  
Polycarbonate

### BC690

.....  
WIDTH  
655mm  
.....  
DEPTH  
458mm  
.....  
HEIGHT  
900mm  
.....  
DOOR OPTIONS:  
MFC, Tambour &  
Polycarbonate



#### HARDWARE

**HANDLES:** Matt Nickel 256mm D type handles secured with M4 machine screws through the door panel.

**HINGES:** Heavy duty Aximat 100 hinges which are LGA tested in compliance with DIN EN 15570 test level 3 (80,000 Cycles). Large opening angle from 180 to 250 degrees provided by external pivot point with integrated automatic closing spring.

**LOCKS:** are fitted as standard on all door types.

CONTACT US NOW FOR A FREE  
NO OBLIGATION QUOTE

Tel: 0161 998 9726  
email: [sales@klicktechnology.co.uk](mailto:sales@klicktechnology.co.uk)  
[www.klicktechnology.co.uk](http://www.klicktechnology.co.uk)

**KLICK** making room for  
your ideas